

INJ90BT-24

Hardened Gigabit PoE Injector

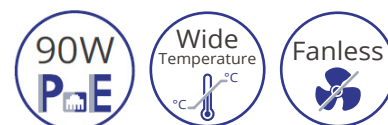

Product Highlights

High-Power PoE (Power over Ethernet)

- High power output using the latest IEEE 802.3bt technology
- Up to 90W output for various security, LED lighting, and other applications
- Backward compatible with 802.3af and 802.3at devices

Hardened-Grade for Non-Ventilated & Harsh Environments

- Wide operating temperature range from -40 to 75°C (-40 to 167°F)
- Fanless operation
- High impact, thermal shock, and electrical noise resistance

Support

- Complimentary Technical Support
- In-person training and free online training courses available
- Limited Lifetime Warranty

Overview

EtherWAN's INJ90BT-24 is a compact hardened DIN-rail mounted PoE injector. Using the latest IEEE 802.3bt PoE technology providing up to 90W power output, the INJ90BT-24 provides the solution required to integrate remote PoE devices such as IP cameras, LED lights, wireless access point, and other network devices into non-PoE networks for reliable operation even in harsh environments.

Ordering Information

Model

INJ90BT-24	10/100/1000BASE-T PoE Injector, 90W 802.3bt
------------	---

Hardware Specifications

Interface		+
Ethernet	1 x 10/100/1000BASE-T(X), connection to network 1 x 10/100/1000BASE-T(X), PoE connection to device	
LED Indicators	Power detected: Power 1, Power 2 PoE: On (Active), Off (Idle)	
Technology		+
Standards	IEEE 802.3 10BASE-T IEEE 802.3u 100BASE-TX/100BASE-FX IEEE 802.3ab 1000BASE-T IEEE 802.3af PoE IEEE 802.3at PoE+ IEEE 802.3bt 4PPoE Compatible with 95W PoH (Power over HDBaseT) standard	
Power		+
Input	24-56VDC redundant (terminal block)	
Power Consumption	1W max @ 48VDC, without PoE	
PoE Power Output	90W @ 56VDC input 60W @ 24VDC input	
Protection	Reverse polarity protection, Current overload protection	
Physical		+
Casing Material	Aluminum	
IP Rating	IP30	
Dimensions	32 x 81.5 x 103.5mm (W x D x H) 1.26" x 3.21" x 4.07"	
Weight	1.5lbs (0.68kg)	
Installation Type	DIN Rail or wall mounting	
Environmental		+
Operating Temp.	-40 to 167°F (-40 to 75°C)	
Storage Temp.	-49 to 185°F (-40 to 85°C)	
Relative Humidity	5% to 95% (non-condensing)	
MTBF	>500,000 hours @ 60°C	
Regulatory		+
ISO	Manufactured in ISO-9001 facility	
EMI	FCC Part 15B Class A EN 55032 EN 55024	
EMS	EN 61000-4-2 (ESD) EN 61000-4-4 (Burst) EN 61000-4-5 (Surge)	
Safety	UL 60950-1	
Vibration	EN 60068-2-6	
Shock	EN 60068-2-27	
Free Fall	EN 60068-2-32	

Warranty		+
Length	Limited Lifetime	
Details	www.etherwan.com/support/warranty-policy	
What's Included		+
Device	Injector	
Installation	Mounting brackets, screws, 4-pin terminal block	
Documentation	Quick install guide	

Dimensions

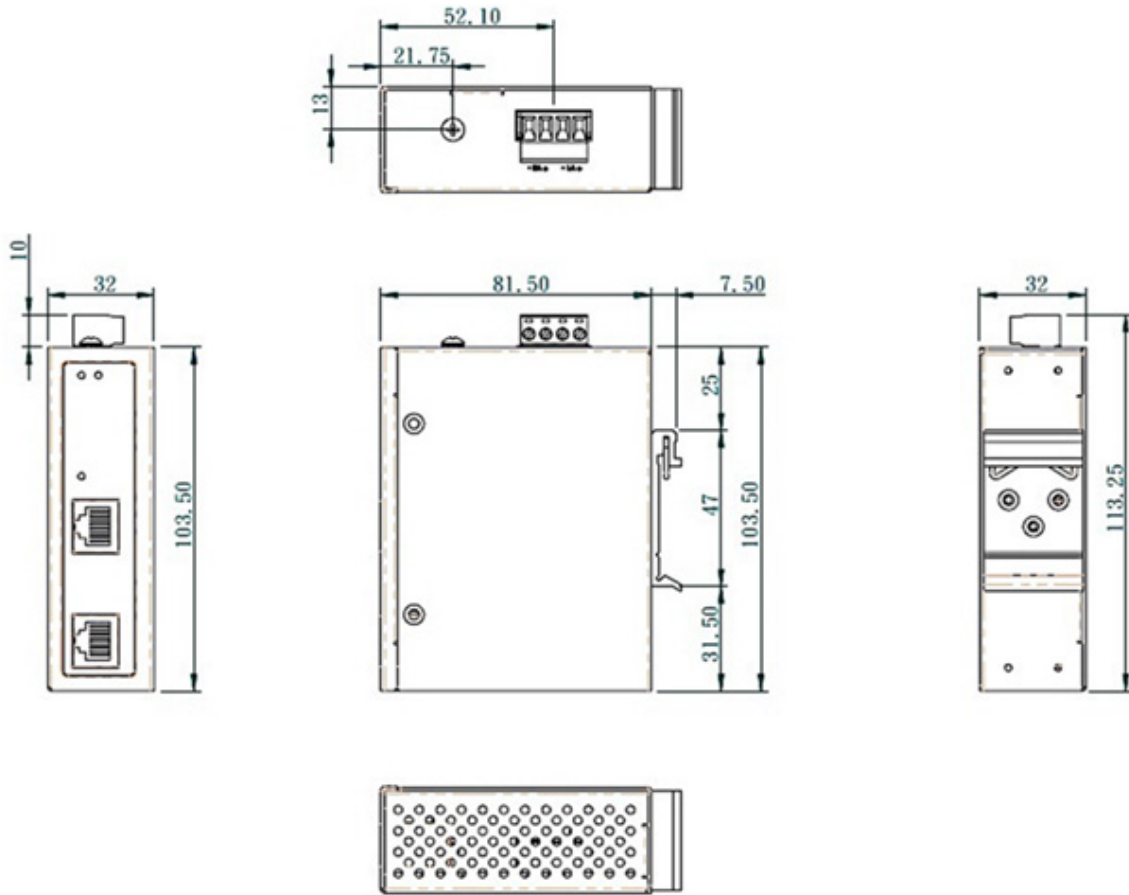

Accessories

DIN-Rail Power Supplies +

www.etherwan.com/products/din-rail-power-supply